

# TRANS-STATE INDUSTRIES, INC.

## "GREEN FRAME"

### GALVESTON, TEXAS 77553

**LEGEND**

- I.R. Set
- I.R. Found
- Catch Basin
- Fence Corner
- ( > ) (Record Call)
- Wood Fence
- Chain Link Fence
- X — X — Barbed Wire Fence
- Hog Wire Fence
- ▨ Concrete
- ▨ Asphalt
- Flow
- + Spot Elevation
- 20' Contour Interval
- ▨ Encroachment
- OE — Overhead Electric Line
- B.L. — Building Line

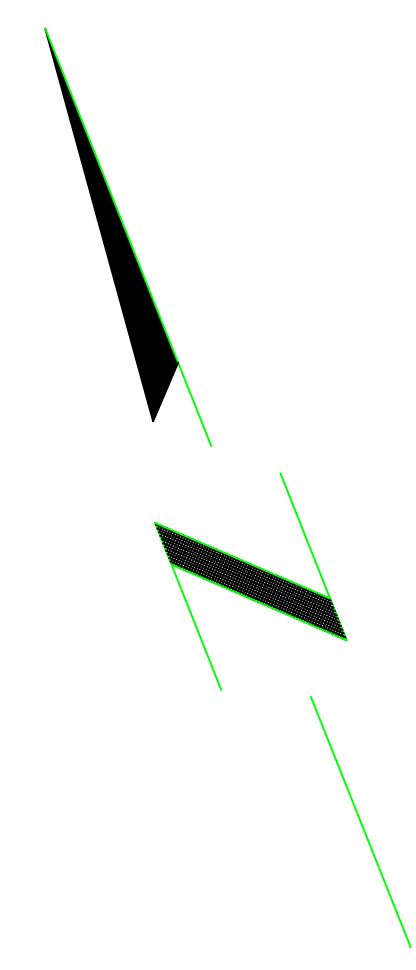

SCALE:  
1" = 30'

HARBORSIDE DRIVE  
(60' R.O.W.)

19th STREET  
(50' R.O.W.)

18th STREET  
(50' R.O.W.)

FARMER COPPER  
&  
CONSTRUCTION CO.

UTMB OFFICES  
ADMINISTRATION

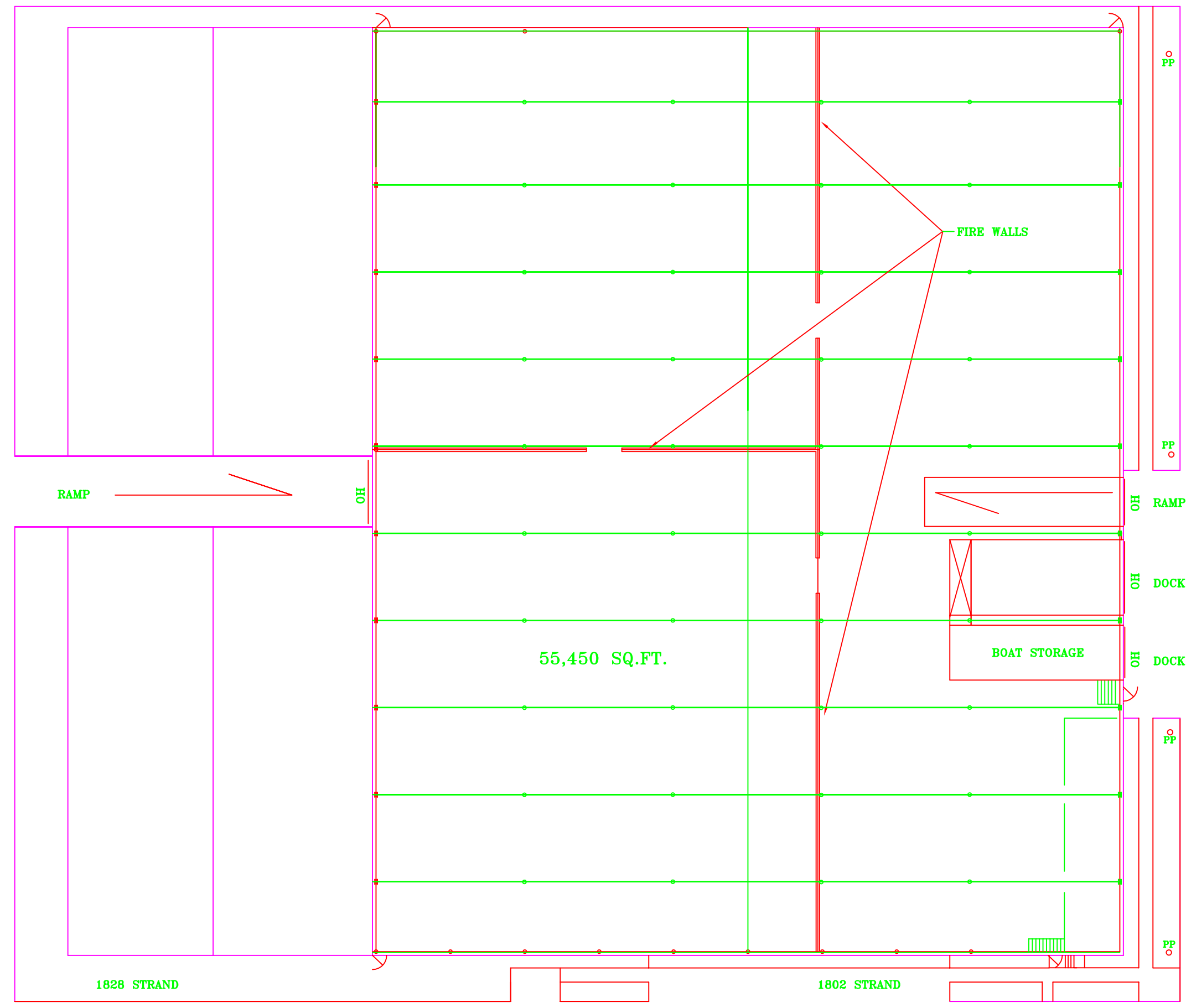

STRAND  
(50' R.O.W.)

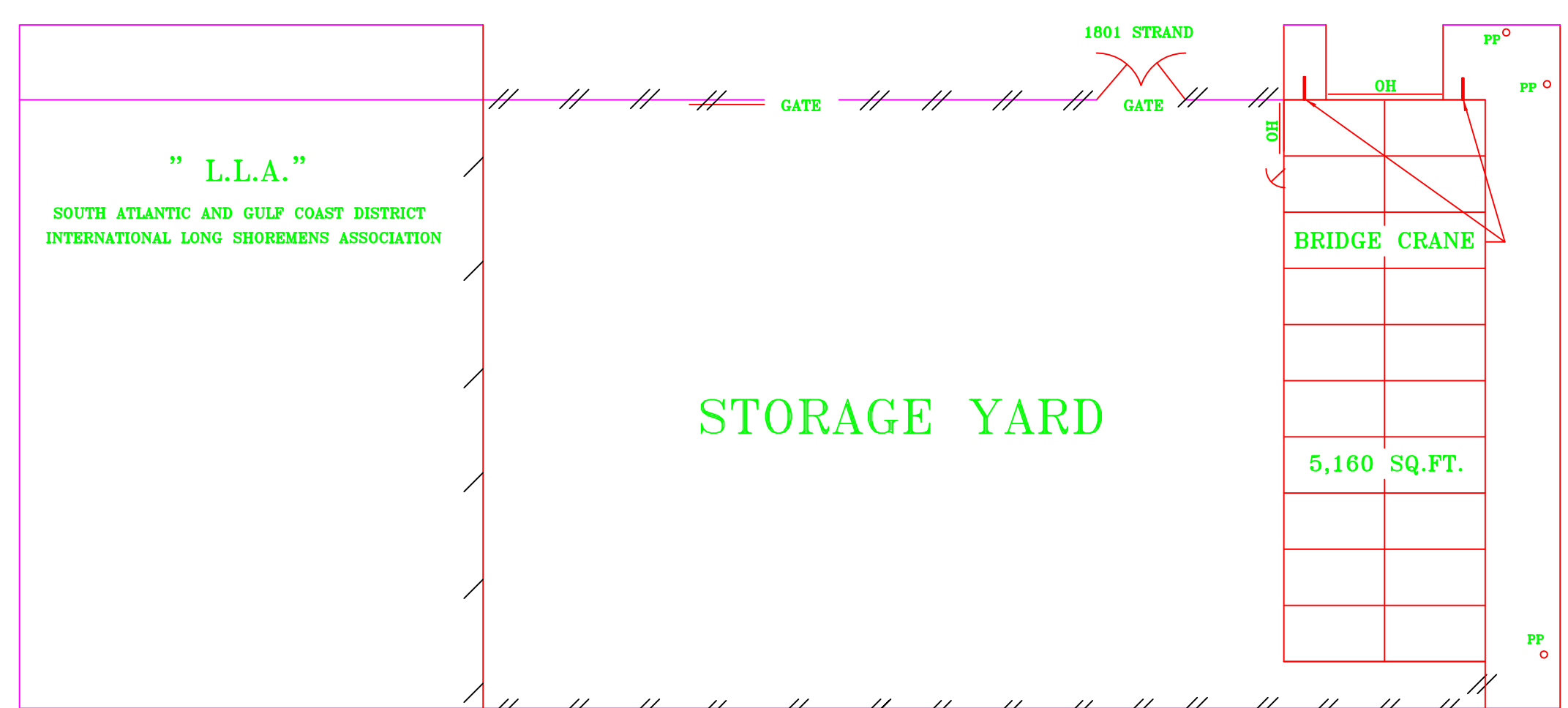

PUBLIC HOUSING  
(VACANT)

SAN JACINTO ENGINEERING, INC.

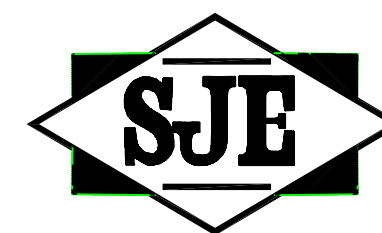

2534 Violet Street  
Pasadena, Texas 77503  
(281) 487-2251  
(281) 487-3017 Fax



C.B. URBAN, P.E. No. 51315  
R.P.L.S. No. 4546

**SAN JACINTO ENGINEERING, INC.**  
**-CONSULTING ENGINEERS-**

**SJE** 2534 VIOLET STREET  
Pasadena, Texas 77503  
(281) 487-2251

DATE: 08/10/09	SCALE: 1" = 30'
DRAWN BY: CU	DWG. NO. 02
AS-BUILT DRAWING	